

161

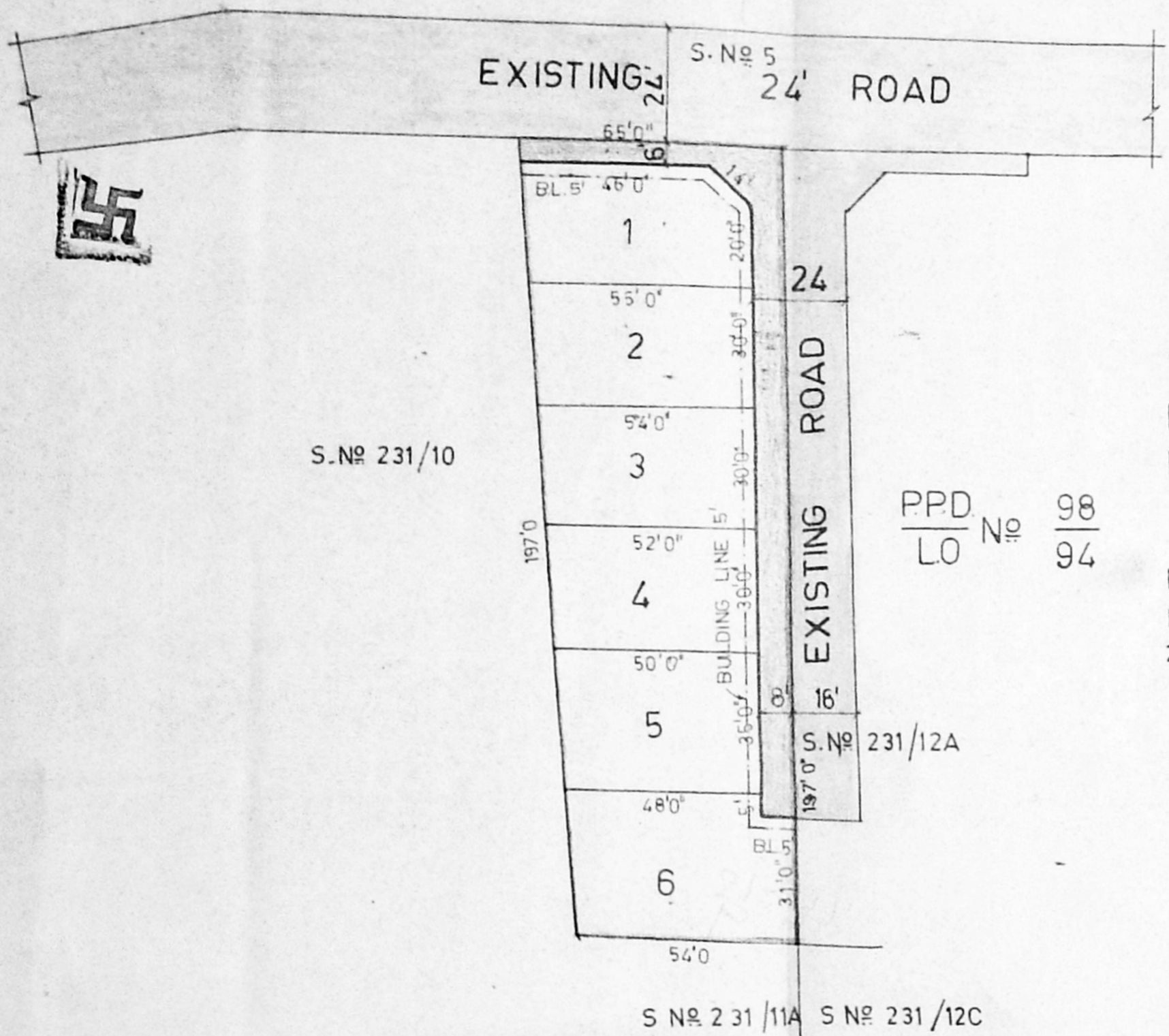

TOTAL EXTENT (0.27AC): 1093 M²
 ROAD AREA : 160 M²
 NO OF PLOTS : 6

NOTE :
 1. SPLAY 10'x10'.
 2. MEASUREMENTS INDICATED ARE EXCLUDING SPLAY DIMENSIONS.

P.P.D. No. 4
 LO. 97

APPROVED

VIDE LETTER No. : L/30385/96
 DATED : 2-2-1997

M. Subramanian
 FOR MEMBER SECRETARY
 CHENNAI METROPOLITAN
 DEVELOPMENT AUTHORITY.

5/5



Traced by

PAI
 3/2/97

AP(L)
 3/2/97

DP (L&M)

ULLAGARAM PUZHUTHIVAKKAM TOWN PANCHAYAT
 PLAN SHOWING THE PROPOSED SUB DIVISION OF HOUSE -
 SITES IN S.No. 231/11B OF MADIPAKKAM VILLAGE.
 SCALE : 66 FEET TO AN INCH.